

# EXPLODED VIEW & PARTS LISTING

## Air Operated Double Diaphragm pump

Model : NDP-P20BP.

**Yamada** Europe B.V.



Material: PPG (Reinforced Polypropylene)



To Purchase:

More information:

☎ 0031 (0)74 242 2032

▶ YouTube: [@yamadapump](https://www.youtube.com/@yamadapump)

✉ [sales@yamada.nl](mailto:sales@yamada.nl)

🌐 [yamada-europe.com](http://yamada-europe.com)

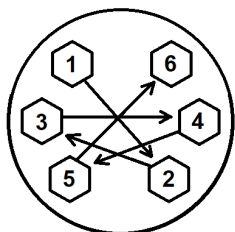
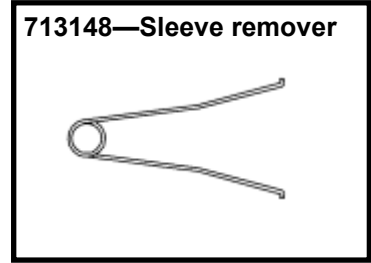
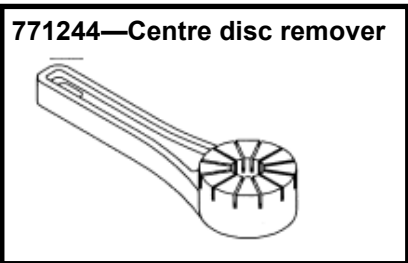
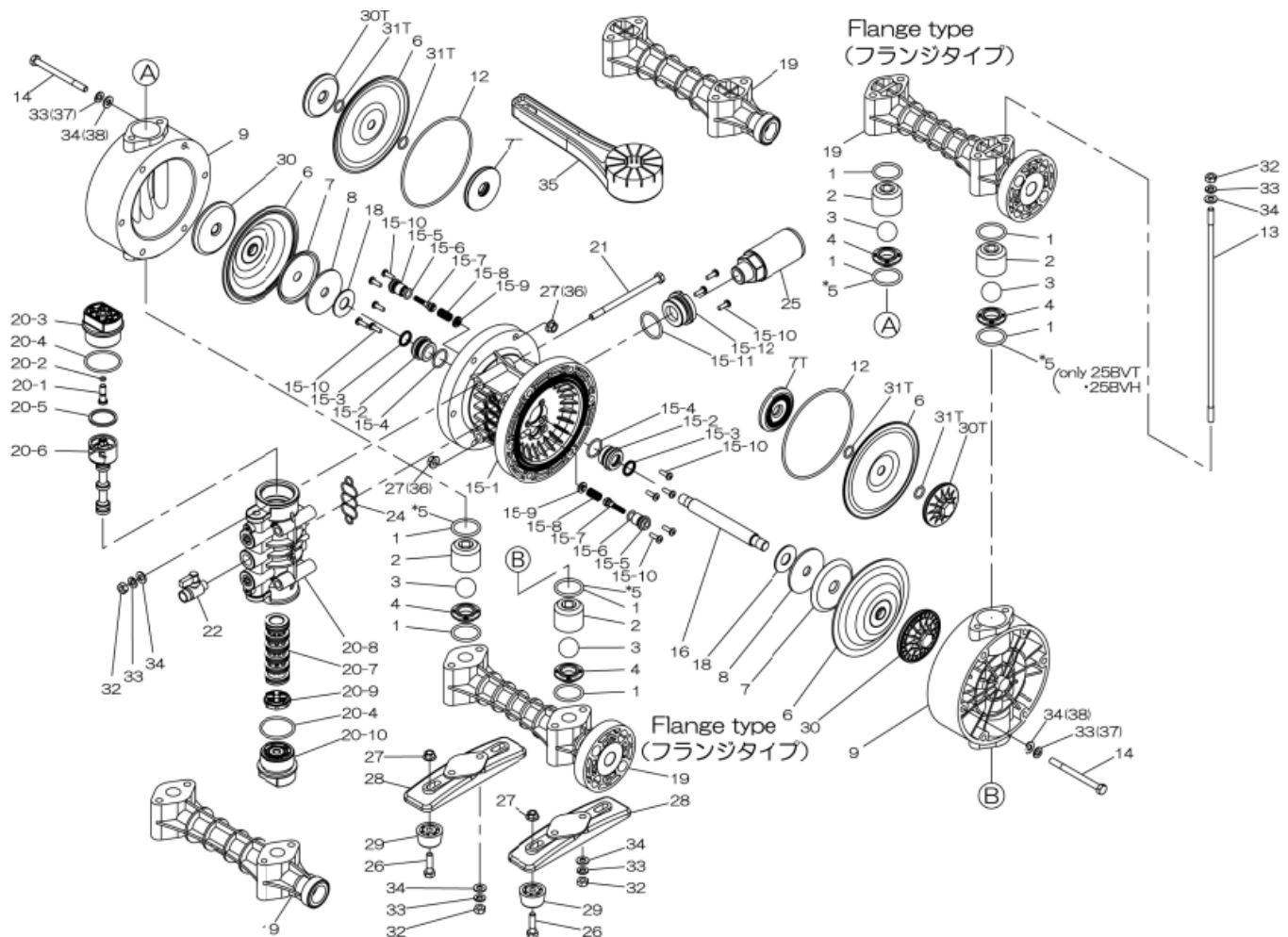

**Tighting torque for:**

Center rod: 40 Nm  
 Center rod TU: **Hand tight**  
 Out chamber: 10/13 Nm  
 Manifold: 10/20 Nm

**Special tools (sold seperately)**

713148 Sleeve remover  
 771244 Centre disc remover

**Miscellaneous:**

Assembly oil: use turbine oil none additional class 1  
 Equiv. to ISO VGA32 grade  
 Use Urea grease grade NLGI No. 2

# EXPLODED VIEW & PARTS LISTING

## Air Operated Double Diaphragm pump

Model : NDP-P20BP.

**Yamada** Europe B.V.



Material: PPG (Reinforced Polypropylene)

### DIAPHRAGM

### Design #

CR	NBR	EPDM	HYTREL	SANTOPRENE	FPM	PTFE	PTFE-EPDM
BPC	BPN	BPE	BPH	BPS	BPV	BPT	BPTU
854080	854081	854082	854085	854086	854083	854084	YE Original



REF. No.	DESCRIPTION	Q'TY.	Part No.	Part No.	Part No.	Part No.	Part No.	Part No.	Part No.	Part No.	Part No.
1	O RING	8	640033	640033	684116	640033	684116	642033	643033	643033	643033
2	BALL GUIDE	4	771216	771216	771216	771216	771216	771216	771216	771216	771216
3	BALL	4	770705	770720	770723	773126	773170	770726	770736	770736	770736
4	VALVE SEAT	4	780137	780137	780137	780137	780137	780137	780137	780137	780137
6	DIAPHRAGM	2	772957	772958	772959	771362	771973	772960	771083	832549	832549
7	CENTER DISK	2	716225	716225	716225	716225	716225	716225	—	—	—
7T	CENTER DISK	2	—	—	—	—	—	—	709456	—	—
8	WASHER	2	716226	716226	716226	716226	716226	716226	—	—	—
9	OUT CHAMBER	2	780134	780134	780134	780134	780134	780134	780134	780134	780134
12	O RING	2	—	—	—	640151	640151	—	640151	640151	640151
13	TIE ROD	4	710122	710122	710122	710122	710122	710122	710122	710122	710122
14	BOLT	12	621166	621166	621166	621166	621166	621166	621166	621166	621166
15	BODY ASSY	1	804603	804603	804603	804603	804603	804603	804603	804603	804603
16	CENTER ROD	1	710252	710252	710252	710252	710252	710252	710252	714674	714674
18	CUSHION	2	771054	771054	771054	771054	771054	771054	771054	771054	771054
19	MANIFOLD	2	780009	780009	780009	780009	780009	780009	780009	780009	780009
20	VALVE BODY ASSY	1	804607	804607	804607	804607	804607	804607	804607	804607	804607
21	BOLT	4	686031	686031	686031	686031	686031	686031	686031	686031	686031
22	VALVE	1	686967	686967	686967	686967	686967	686967	686967	686967	686967
24	GASKET	1	772848	772848	772848	772848	772848	772848	772848	772848	772848
25	MUFFLER	1	804697	804697	804697	804697	804697	804697	804697	804697	804697
26	BOLT	4	621151	621151	621151	621151	621151	621151	621151	621151	621151
27	FLANGED NUT	16	686032	686032	686032	686032	686032	686032	686032	686032	686032
28	BASE	2	771219	771219	771219	771219	771219	771219	771219	771219	771219
29	RUBBER FOOT	4	770551	770551	770551	770551	770551	770551	770551	770551	770551
30	CENTER DISK	2	780123	780123	780123	780123	780123	780123	—	772562	772562
30T	CENTER DISK	2	—	—	—	—	—	—	780124	—	—
31T	O RING	4	—	—	—	—	—	—	643013	—	—
32	NUT	12	683635	683635	683635	683635	683635	683635	683635	683635	683635
33	SPRING WASHER	24	681300	681300	681300	681300	681300	681300	681300	681300	681300
34	PLAIN WASHER	24	631329	631329	631329	631329	631329	631329	631329	631329	631329
35	SPECIAL TOOL	2	771244	771244	771244	771244	771244	771244	771244	—	—
KIT	DIAPHRAGM		KP20D-PC	KP20D-PN	KP20D-PE	K20D-PH	K20D-PS	KP20D-PV	K20D-PT	K20D-PTU	K20D-PTU
KIT	VALVE		K20V-PC	K20V-PN	K20V-PE	K20V-PH	K20V-PS	K20V-PV	K20V-PT	K20V-PT	K20V-PT
KIT	WET END REPAIR		K20-PC-PP	K20-PN-PP	K20-PE-PP	K20-PH-PP	K20-PS-PP	K20-PV-PP	K20-PT-PP	K20-PTU-PP	K20-PTU-PP
KIT	AIR MOTOR		KP20/25-AM								
KIT	AIR MOTOR SEAL		KP20/25-AMS								

# EXPLODED VIEW & PARTS LISTING

Model : NDP-P20BP.

**Yamada** Europe B.V.



## Air Operated Double Diaphragm pump

Material: PPG (Reinforced Polypropylene)



**DIAPHRAGM**

**Design #**

CR	NBR	EPDM	HYTREL	SANTOPRENE	FPM	PTFE	PTFE-EPDM
BPC	BPN	BPE	BPH	BPS	BPV	BPT	BPTU
854080	854081	854082	854085	854086	854083	854084	YE Original

REF. No.	DESCRIPTION	Q'TY.	Part No.	Part No.	Part No.	Part No.	Part No.	Part No.	Part No.	Part No.
15- 1	BODY	1					772928			
*15- 2	THROAT BEARING	2					772931			
15- 3	PACKING	2					685414			
15- 4	O RING	2					685276			
15- 5	VALVE SEAT	2					772932			
15- 6	O RING	2					640009			
15- 7	PILOT VALVE ASSY	2					802360			
15-7-1	O RING SEAL PILOT VALVE	2					771374			
15- 8	SPRING	2					708666			
15- 9	SPRING SEAT	2					772948			
15-10	TAPPING SCREW	13					686030			
15-11	O RING	1					640132			
15-12	BUSHING	1					772933			
20- 1	RESET BUTTON	1					772991			
20- 2	O RING	1					640002			
20- 3	CAP A	1					772946			
20- 4	O RING	2					640043			
20- 5	PACKING	1					771241			
20- 6	C SPOOL ASSY	1					802400			
20- 7	SLEEVE ASSY	1					804609			
20-7-1	O RING	6					686029			
20- 8	VALVE BODY ASSY	1					832902			
20- 9	CUSHION	1					771914			
20-10	CAP B	1					772947			
KIT	AIR MOTOR						KP20/25-AM			
KIT	AIR MOTOR SEAL						KP20/25-AMS			

! \* Throat bearing position 15-2, 772931 is only available as an assembly. Positions 15-2, 15-3 and 15-4. Article code 020931

# EXPLODED VIEW & PARTS LISTING

## Air Operated Double Diaphragm pump



Model : NDP-P20BP.

**Yamada** Europe B.V.



Material: PPG (Reinforced Polypropylene)

Diaphragm options	CR, NBR, EPDM, FPM, TPEE, TPO	PTFE	TU
Max performance	110 L/min	100 L/min	85 L/min
Manifold connection	Rc 3/4"		
Net Weight	8,2 kg		

MODEL : NDP-P20BP.

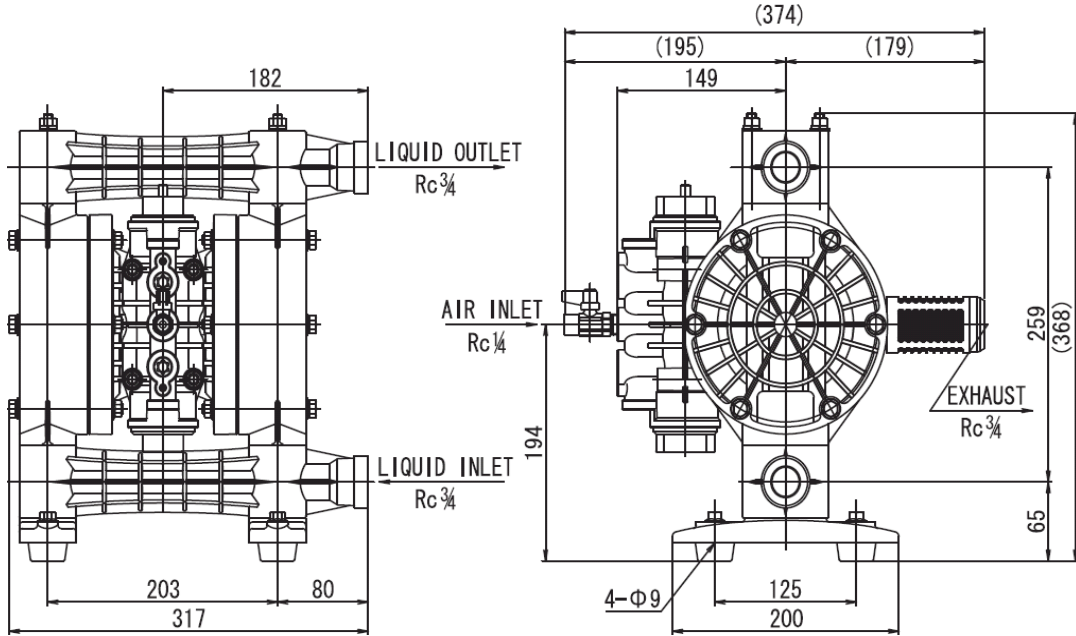

■ NDP-P20BA □/BS □/BP □

0,1MPa = 1Bar

NDP-P20BPT

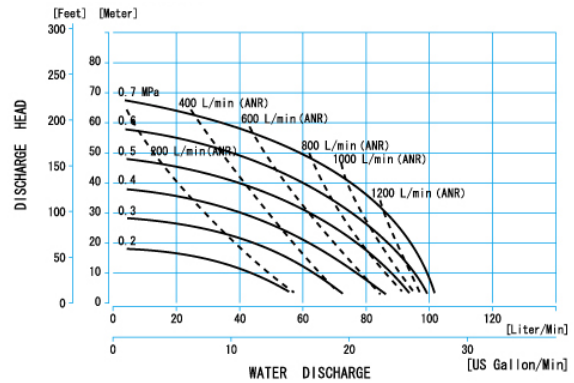
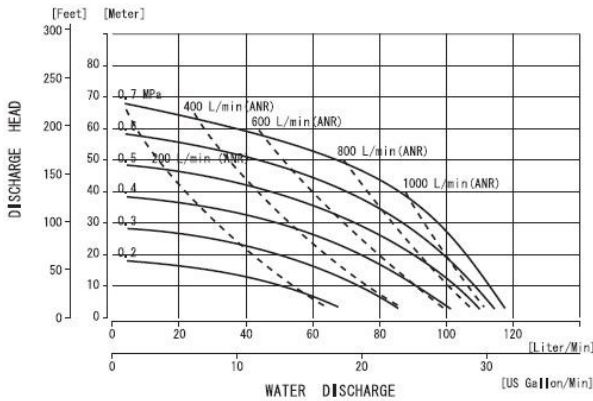

NDP-P24BPTU

