

# EXPLODED VIEW & PARTS LISTING

## Air Operated Double Diaphragm pump

Model : NDP-P25BP.

**Yamada** Europe B.V.



Material: PPG (Reinforced Polypropylene)



To Purchase:

More information:

☎ 0031 (0)74 242 2032

▶ YouTube: [@yamadapump](https://www.youtube.com/@yamadapump)

✉ [sales@yamada.nl](mailto:sales@yamada.nl)

🌐 [yamada-europe.com](http://yamada-europe.com)

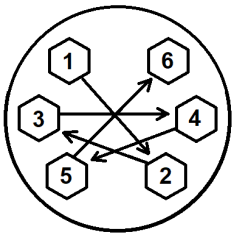
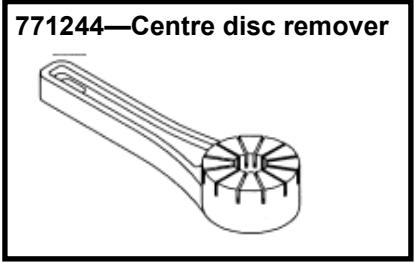
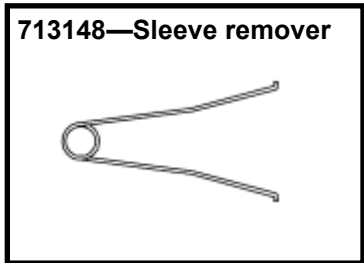
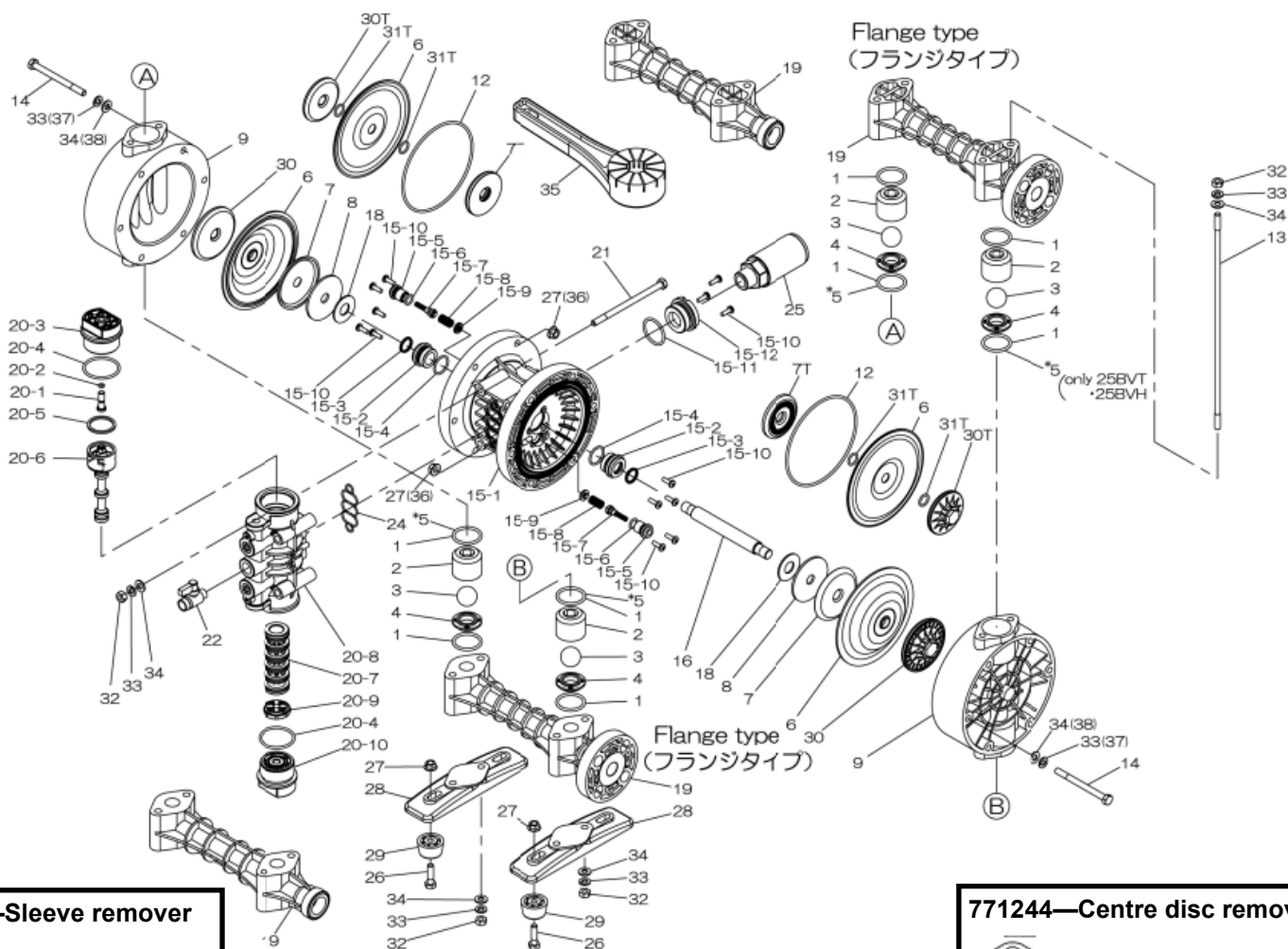

**Tighting torque for:**

Center rod: 40 Nm  
 Center rod TU: **Hand tight**  
 Out chamber: 10/20 Nm  
 Manifold: 10/12 Nm

**Special tools (sold seperately)**

713148 Sleeve remover  
 771244 Centre disc remover

**Miscellaneous:**

Assembly oil: use turbine oil none additional class 1  
 Equiv. to ISO VGA32 grade  
 Use Urea grease grade NLGI No. 2

# EXPLODED VIEW & PARTS LISTING

## Air Operated Double Diaphragm pump

Model : NDP-P25BP.

**Yamada** Europe B.V.



Material: PPG (Reinforced Polypropylene)

### DIAPHRAGM

### Design #



CR	NBR	EPDM	HYTREL	SANTOPRENE	FPM	PTFE	PTFE-EPDM
BPC	BPN	BPE	BPH	BPS	BPV	BPT	BPTU
854157	854158	854159	854162	854163	854160	854161	YE Original

REF. No.	DESCRIPTION	Q'TY.	Part No.	Part No.	Part No.	Part No.	Part No.	Part No.	Part No.	Part No.	Part No.
1	O RING	8	640042	640042	684119	640042	684119	642042	643042	643042	643042
2	BALL GUIDE	4	771231	771231	771231	771231	771231	771231	771231	771231	771231
3	BALL	4	770556	770581	770590	773127	773171	770599	770691	770691	770691
4	VALVE SEAT	4	780138	780138	780138	780138	780138	780138	780138	780138	780138
6	DIAPHRAGM	2	772961	772962	772963	771363	771974	772964	771110	832584	832584
7	CENTER DISK	2	716258	716258	716258	716258	716258	716258	—	—	—
7T	CENTER DISK	2	—	—	—	—	—	—	709459	—	—
8	WASHER	2	716259	716259	716259	716259	716259	716259	—	—	—
9	OUT CHAMBER	2	780135	780135	780135	780135	780135	780135	780135	780135	780135
12	O RING	2	—	—	—	640154	640154	—	640154	640154	640154
13	TIE ROD	4	710207	710207	710207	710207	710207	710207	710207	710207	710207
14	BOLT	12	683541	683541	683541	683541	683541	683541	683541	683541	683541
15	BODY ASSY	1	804604	804604	804604	804604	804604	804604	804604	804604	804604
16	CENTER ROD	1	710271	710271	710271	710271	710271	710271	710271	710271	714812
18	CUSHION	2	771054	771054	771054	771054	771054	771054	771054	771054	771054
19	MANIFOLD	2	780011	780011	780011	780011	780011	780011	780011	780011	780011
20	VALVE BODY ASSY	1	804607	804607	804607	804607	804607	804607	804607	804607	804607
21	BOLT	4	686031	686031	686031	686031	686031	686031	686031	686031	686031
22	VALVE	1	686969	686969	686969	686969	686969	686969	686969	686969	686969
24	GASKET	1	772848	772848	772848	772848	772848	772848	772848	772848	772848
25	MUFFLER	1	804697	804697	804697	804697	804697	804697	804697	804697	804697
26	BOLT	4	621153	621153	621153	621153	621153	621153	621153	621153	621153
27	FLANGED NUT	4	686032	686032	686032	686032	686032	686032	686032	686032	686032
28	BASE	2	771235	771235	771235	771235	771235	771235	771235	771235	771235
29	RUBBER FOOT	4	770551	770551	770551	770551	770551	770551	770551	770551	770551
30	CENTER DISK	2	780125	780125	780125	780125	780125	780125	—	772620	772620
30T	CENTER DISK	2	—	—	—	—	—	—	780126	—	—
31T	O RING	4	—	—	—	—	—	—	643013	—	—
32	NUT	12	683635	683635	683635	683635	683635	683635	683635	683635	683635
33	SPRING WASHER	12	681300	681300	681300	681300	681300	681300	681300	681300	681300
34	PLAIN WASHER	12	631329	631329	631329	631329	631329	631329	631329	631329	631329
35	SPECIAL TOOL	2	771244	771244	771244	771244	771244	771244	771244	771244	771244
36	FLANGED NUT	12	686033	686033	686033	686033	686033	686033	686033	686033	686033
37	SPRING WASHER	12	680257	680257	680257	680257	680257	680257	680257	680257	680257
38	PLAIN WASHER	12	631330	631330	631330	631330	631330	631330	631330	631330	631330
KIT	DIAPHRAGM		KP25D-PC	K25D-PN	K25D-PE	K25D-PH	K25D-PS	K25D-PV	K25D-PT	K25D-PTU	K25D-PTU
KIT	VALVE		K25V-PC	K25V-PN	K25V-PE	K25V-PH	K25V-PS	K25V-PV	K25V-PT	K25V-PT	K25V-PT
KIT	WET END REPAIR		K25-PC-PP	K25-PN-PP	K25-PE-PP	K25-PH-PP	K25-PS-PP	K25-PV-PP	K25-PT-PP	K25-PTU-PP	K25-PTU-PP
KIT	AIR MOTOR										KP20/25-AM
KIT	AIR MOTOR SEAL										KP20/25-AMS

# EXPLODED VIEW & PARTS LISTING

Model : NDP-P25BP.

**Yamada** Europe B.V.



## Air Operated Double Diaphragm pump

Material: PPG (Reinforced Polypropylene)



**DIAPHRAGM**

**Design #**

CR	NBR	EPDM	HYTREL	SANTOPRENE	FPM	PTFE	PTFE-EPDM
BPC	BPN	BPE	BPH	BPS	BPV	BPT	BPTU
854157	854158	854159	854162	854163	854160	854161	YE Original

REF. No.	DESCRIPTION	Q'TY.	Part No.	Part No.	Part No.	Part No.	Part No.	Part No.	Part No.	Part No.
15- 1	BODY	1					772929			
*15- 2	THROAT BEARING	2					772931			
15- 3	PACKING	2					685414			
15- 4	O RING	2					685276			
15- 5	VALVE SEAT	2					772932			
15- 6	O RING	2					640009			
15- 7	PILOT VALVE ASSY	2					802360			
15-7-1	O RING SEAL PILOT VALVE	2					771374			
15- 8	SPRING	2					708666			
15- 9	SPRING SEAT	2					772948			
15-10	TAPPING SCREW	13					686030			
15-11	O RING	1					640132			
15-12	BUSHING	1					772933			
20- 1	RESET BUTTON	1					772991			
20- 2	O RING	1					640002			
20- 3	CAP A	1					772946			
20- 4	O RING	2					640043			
20- 5	PACKING	1					771241			
20- 6	C SPOOL ASSY	1					802400			
20- 7	SLEEVE ASSY	1					804609			
20-7-1	O RING	6					686029			
20- 8	VALVE BODY ASSY	1					832902			
20- 9	CUSHION	1					771914			
20-10	CAP B	1					772947			
KIT	<b>AIR MOTOR</b>						KP20/25-AM			
KIT	<b>AIR MOTOR SEAL</b>						KP20/25-AMS			

! \* Throat bearing position 15-2, 772931 is only available as an assembly. Positions 15-2, 15-3 and 15-4. Article code 020931

# EXPLODED VIEW & PARTS LISTING

## Air Operated Double Diaphragm pump



**MODEL :** NDP-P25BP.

Model : NDP-P25BP.

**yamada** Europe B.V.



Material: PPG (Reinforced Polypropylene)

Diaphragm options	CR, NBR, EPDM, FPM, TPEE, TPO, PTFE, TU
Max performance	160 L/min
Manifold connection	Rc 1"
Net Weight	11,0 kg

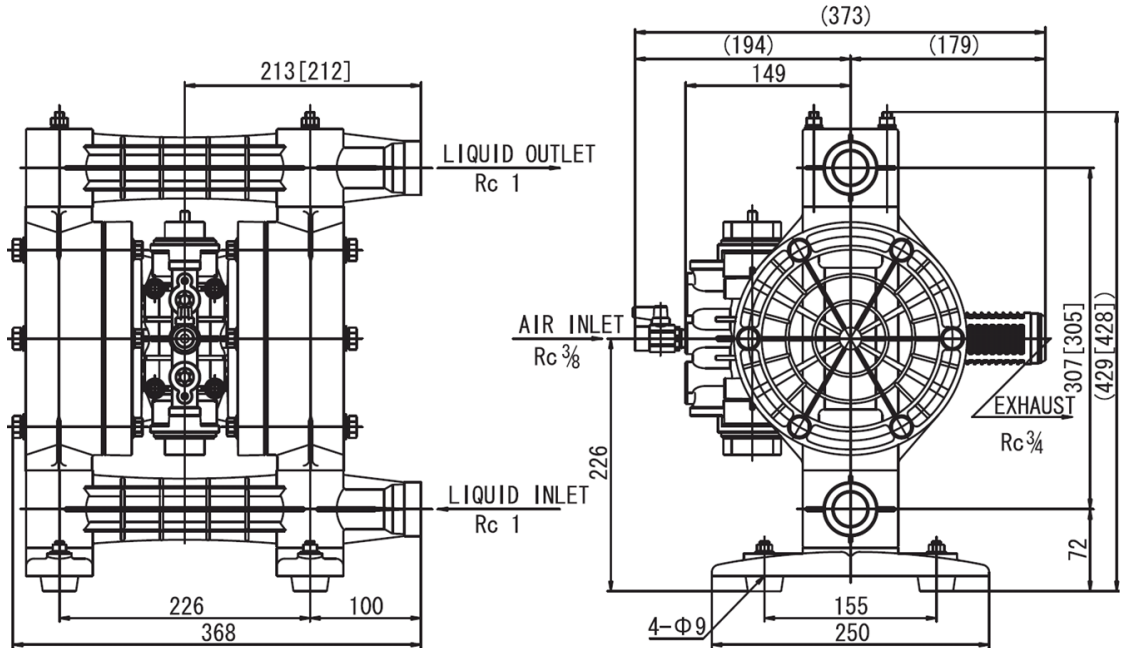

■ NDP-P25BA □ / BS □ / BP □ / BV □

0,1MPa = 1Bar

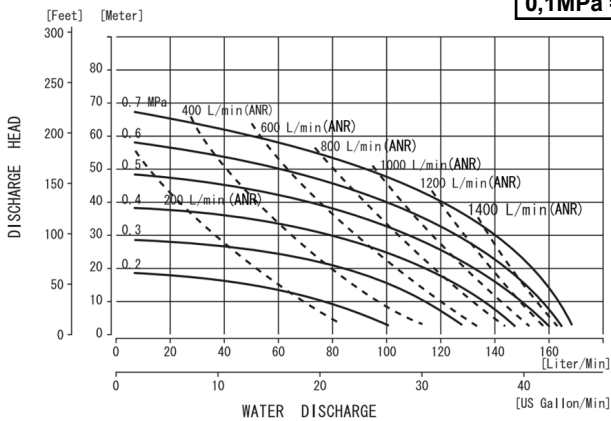

NDP-25BPT, BVT flange

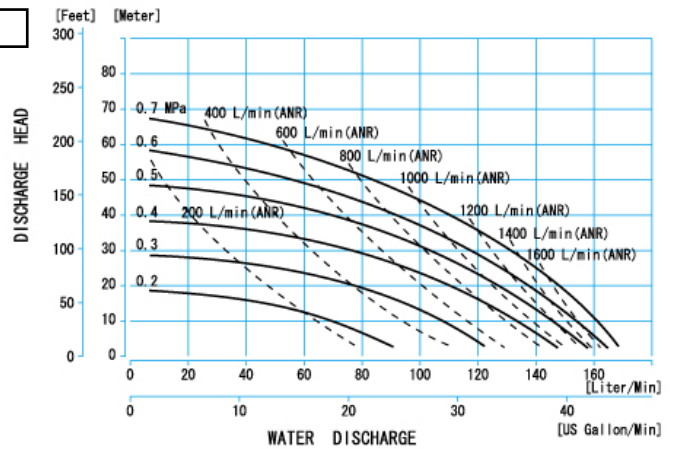

NDP-P24BPTU

